



SWIFT
CREATING SMILES FOR LIFE

love lodges

love life
LOVE SWIFT

2022 LODGE RANGE

UNDER OUR OWN BLUE SKY

Take me to a place that I call Here,
Hold me in a time that I call This
The air is clean, the light is clear
And now an outdoor kind of bliss
Draws me to a spot I really love;
The door wide open, the kettle on,
A family that fits me like a glove.

A moment's pause for those who've gone
Who still remain in the mind and heart.

And now, under our very own blue sky
The rest of our lives can slowly start
And our spirits can begin to fly
With memories of where we've been,
Those mornings we have yet to know
Those brand new vistas all unseen.
Love life, I say. And now, let's go!

©Ian McMillan 2021

love life
LOVE SWIFT



LODGE RANGE

Welcome to Swift's 2022 lodge collection, where you'll find your sanctuary. Across these exceptional ranges are stylish, relaxing and practical spaces, providing luxury retreats from everyday life. Make new memories and reconnect with loved ones, while enjoying the sophisticated design and superior fittings that set Swift products apart.

CONTENTS

- 04 SWIFT SUPERIOR STANDARD
- 06 TORONTO
- 10 EDMONTON
- 14 VENDEE
- 18 MOSELLE
- 22 LODGES AT A GLANCE
- 24 THE SWIFT DIFFERENCE
- 26 LODGE DIMENSIONS
- 28 FINISHES AND SOFT FURNISHINGS



SWIFT SUPERIOR STANDARD

There's no better feeling than stepping into your lodge for a relaxing getaway, so we do everything possible to make that feeling last for years to come.

We pride ourselves on applying superior manufacturing quality to everything we produce, giving you the confidence that your investment is protected and built to last. With the comfort of total assurance in your purchase, you can get on with the important things in life - making smiles and enjoying unforgettable getaways.

And prioritising your peace of mind, we offer outstanding warranties, including a 3-year Manufacturer Supersure Warranty, 5-year Structural Warranty and 10-year Chassis Warranty.



EXCLUSIVE DUVALAY™ MATTRESSES
All beds feature indulgent Duvalay™ mattresses for the best nights' sleep possible



STAIN RESISTANT CARPETS
With stain resistant carpets, there's no need to waste your precious holiday time scrubbing



BONDED EXTERIOR WALLS
'Sandwich' construction walls provide a more rigid exterior, bonded with insulation in the middle



FULLY GALVANISED CHASSIS
Protecting your lodge, Swift's robust, fully galvanised fusion or I Beam chassis resist corrosion



ELECTRICAL AND USB SOCKETS
Stay connected with electrical and USB sockets in selected areas keeping everything charged



HIGH THERMAL EFFICIENCY
Enjoy outstanding thermal efficiency, proven by environmental chamber testing and calculations

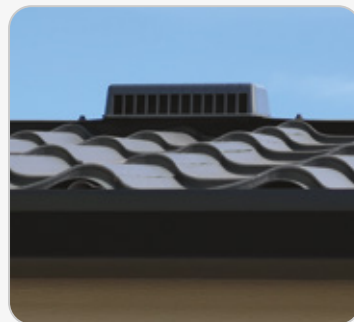

EXTERNALLY VENTED EXTRACTORS
Keep your lodge fresh and dry with externally vented extractors, preventing damp and odours



INTEGRATED MICROWAVES
Optimising valuable work surface space, all Swift lodges feature integrated microwaves



INTEGRATED FRIDGE FREEZERS
Integrated fridge freezers are included across all ranges to maintain a sleek, uncluttered look



LED CEILING LIGHTS
Benefitting the environment and your pocket, bright, low energy LED lighting is included throughout





The twin unit Toronto Lodge is about luxurious family living with a fresh interior, including a choice of design schemes between the contemporary Zodiac or the delightful Butterscotch option, available in both 2 and 3 bed models. From the large wraparound dining seating, airy living area and state of the art kitchen, to the triple crossover bunk room* and clever storage solutions, it's a true home from home.

Model size	Bedrooms	Main Bed	Twin Beds	Rear Bunk Room
40' x 20'	2	2.02m x 1.53m (6'8" x 5'0")	1.83m x 0.92m (6'0" x 3'0")	N/A
42' x 20'	3	2.02m x 1.53m (6'8" x 5'0")	1.83m x 0.92m (6'0" x 3'0")	1.83m x 0.92m (6'0" x 3'0")

*Three-bed model only

TORONTO FEATURES

Along with the Swift Superior Standard (see page 4), Toronto also comes with many desirable extras including:

- Double Glazing
- Central Heating Boiler
- Cooker
- Electric Fire
- Wardrobe
- Branded TV
- Dishwasher
- Wine Cooler
- Washer / Dryer
- 7ft Wall Height
- Heated Towel Rail





Padded headboards



Spacious walk-in shower cubicle



Three crossover bunks

FEATURES

EXTERIOR

- Residential specification built to BS3632:2015
- 20ft twin unit with 10ft and 10ft split
- Strong I Beam twin-axle chassis with galvanised finish warrantied for ten years
- Bonded sandwich exterior wall construction for greater strength
- Coated steel pantile roof
- CanExel high density wood composite cladding with durable realistic woodgrain texture in Timberwolf and Mist Grey with anthracite window frames
- Front aspect French doors
- Large front feature window to dining area
- uPVC windows with push-button security locks
- PVC gutters and down pipes
- Low energy exterior light and downlights under front eaves
- Exterior 240V mains socket

INSULATION

- Excellent thermal performance and sound insulation:
 - 'Thermaglas' uPVC double glazed windows and doors with improved thermal rating
 - 100mm composite SIPs (Structural Insulated Panel) floor
 - 200mm insulation in roof
 - 95mm insulation in walls
 - Lagged underfloor pipes

INTERIOR

- 7ft (2.13m) high ceilings at side walls
- Zodiac soft furnishing scheme
- Luxury carpet with underlay
- Dark grey French Oak laminate effect vinyl flooring in kitchen and dining area
- Nebraska Oak woodgrain
- Modern planked ceiling system
- 30kW gas combi-boiler central heating and hot water system
- Wireless programmable room thermostat
- Radiator thermostats
- Loft style feature wall with display table and shelf in hallway
- Low energy LED ceiling lights
- USB sockets
- Double electric sockets throughout

ENTRANCE HALL

- Large walk-in cupboard housing boiler, freestanding washer / dryer, coat hooks, shoe shelving, two extractor fans and storage
- Contemporary shelving style and clear acrylic feature wall divide near entrance door

LOUNGE

- Freestanding two-seater and three-seater sofas with separate chair, bolsters and scatter cushions
- Dedicated entertainment unit featuring:
 - Branded 40" TV over fireplace and Sky TV cable for connection only
 - LED backlit shelving to both sides
 - Dedicated shelving and sockets for DVD player
 - Fireplace with 2kW Optiflame® feature fire
- Feature coffee table with two cube stools stored underneath
- Full height feature radiator
- Large wall mirror

KITCHEN / DINING

- Glass fronted electric oven and grill
- Five-burner gas hob with central wok burner and electronic ignition
- Curved glass externally vented extractor fan unit with lights
- Integrated microwave oven (800w)*
- Integrated fridge and freezer
- Integrated 12 place setting dishwasher
- Wine cooler
- Large 'U' shape matte kitchen with shaker style doors and breakfast bar with three stools
- **NEW** Silver Grey Metal Slate 40mm laminate worktops with matching upstands
- Soft close drawers
- Pop-up socket provision in worktop
- 1½ premium black granite effect sink/drainer with matte black tap
- Roof VELUX over kitchen units
- Helsinki wooden dining table with wraparound corner seating and three dining chairs
- Loft style feature wall in dining area

BATHROOM(S)

- Shower cubicle with thermostatic shower in main bathroom and en suite (3 bed model)
- Shower cubicle with thermostatic shower in main bathroom and bath in en suite (2 bed model)
- Dual flush WC with soft close toilet seat
- LED illuminated vanity mirrors with infrared sensor and demisting pad
- Metallic silver vanity splashbacks
- Chrome finish towel radiators
- Stone effect vinyl flooring
- Roof VELUX in main bathroom
- Extractor fan in main bathroom and en suite

MAIN BEDROOM

- King-size double bed in main bedroom with lift up storage, feature panel above headboard and overhead storage
- King-size Duvalay™ Alba-Ortho; high-quality orthopaedic mattress providing enhanced orthopaedic care and support for backs, and topped with the finest springy wool for comfort and durability
- Ottoman for extra storage with upholstered seat top (3 bed model)
- Large wardrobe with opening mirrored doors and concealer drawer unit (3 bed model)
- Vanity unit with mirror, drawer unit, cube stool and overhead TV position (3 bed model)
- Separate dressing room with wardrobe, drawers and dressing table (2 bed model)

FLOORPLANS

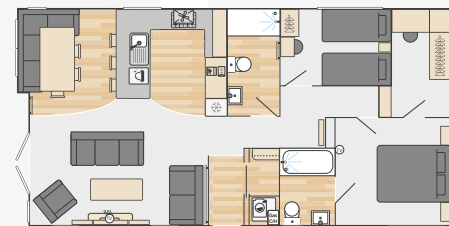

40' x 20' - 2 Bedroom

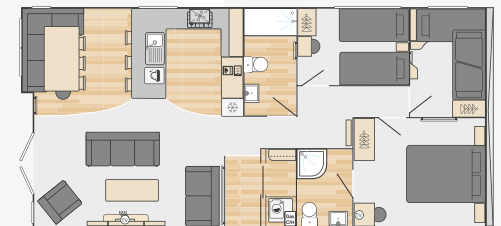

42' x 20' - 3 Bedroom

*The model fitted may differ from that shown in images, please check with supplying dealer or park











Find your slice of the Hamptons right here in Britain with Edmonton, the high-specification new twin-unit lodge perfect for all-season getaways.

Available in a choice of two or three-bedroom models, Edmonton really is a style statement, characterised by fresh, airy palettes and a relaxed coastal cottage atmosphere, combining 'reclaimed' nautical touches with impeccable luxury.

Model size	Bedrooms	Main Bed	Twin Beds	Rear Twin Beds
40' x 20'	2	2.02m x 1.53m (6'8" x 5'0")	1.83m x 0.92m (6'0" x 3'0")	
40' x 20'	3	2.02m x 1.53m (6'8" x 5'0")	1.83m x 0.92m (6'0" x 3'0")	1.83m x 0.92m (6'0" x 3'0")

EDMONTON FEATURES

Along with the Swift Superior Standard (see page 4), Edmonton also comes with many desirable extras including:

-  Double Glazing
-  Central Heating Boiler
-  Cooker
-  Wardrobe
-  TV Point
-  Electric Fire
-  7ft Wall Height
-  Bath
-  Heated Towel Rail



Contemporary fireplace



Cloakroom





King size bed with lift-up storage

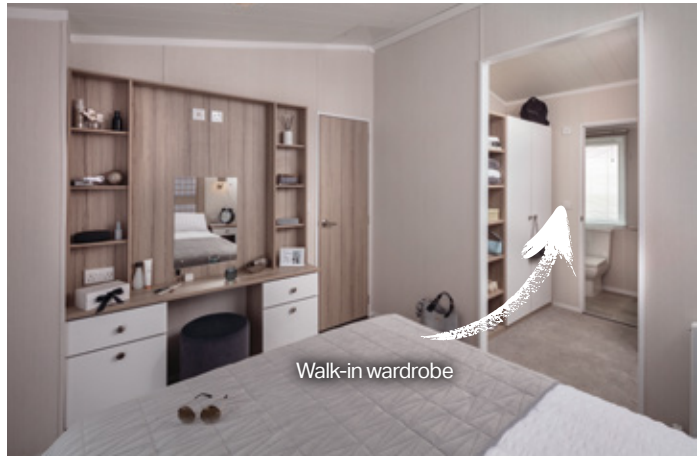

Walk-in wardrobe

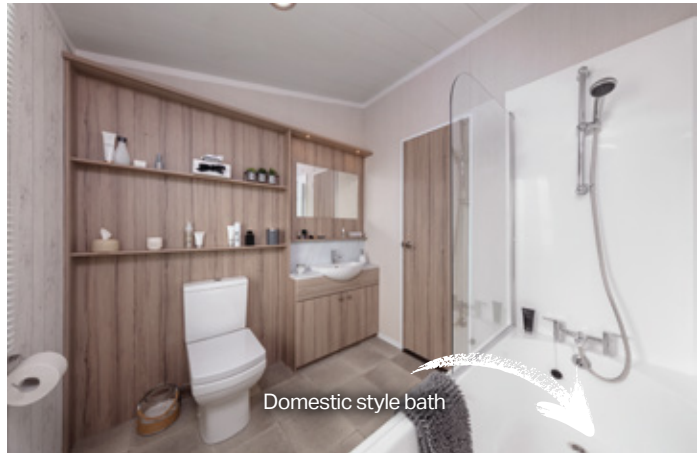

Domestic style bath

FEATURES

EXTERIOR

- Residential specification built to BS3632:2015
- 20ft wide twin unit with 10ft and 10ft split
- Fully galvanised Protech 900 chassis, warrantied for ten years
- Bonded sandwich exterior wall construction for greater strength
- Coated steel pantile roof
- CanExel high density wood composite cladding with durable realistic woodgrain texture in 'Mist Grey' with anthracite window frames
- Front aspect French doors
- Large front feature windows to dining area
- uPVC windows with push-button security locks
- PVC gutters and down pipes
- Low energy exterior light and downlights under front eaves
- Exterior 240V mains socket

INSULATION

- Excellent thermal performance and sound insulation:
 - 'Thermaglas' uPVC double glazed windows and doors with improved thermal rating
 - 100mm composite SIPs (Structural Insulated Panel) floor
 - 200mm insulation in roof
 - 95mm insulation in walls
 - Lagged underfloor pipes

INTERIOR

- 7ft (2.13m) high ceilings at side walls
- Enhanced roof pitch
- Wedgewood soft furnishing scheme
- Luxury carpet with underlay
- Tournai Stone vinyl flooring in kitchen and dining area
- Tisano Oak woodgrain
- Modern planked ceiling system
- 30kW gas combi-boiler central heating and hot water system
- Radiator thermostats
- Low energy LED ceiling lights throughout
- USB sockets
- Double electric sockets throughout

ENTRANCE HALL

- Glazed hallway door
- Utility room housing gas boiler, and space for optional freestanding washer / dryer
- Cloak hooks and shoe storage area

LOUNGE

- Freestanding two-seater and three-seater sofas with scatter cushions
- Upholstered foot stool
- Contemporary fireplace with 2kW Reo Stove
- Freestanding TV unit with storage
- Two TV points - high and low level
- Feature wall panels in Matt Dakar
- Seascape picture above fireplace

KITCHEN / DINING

- Glass fronted electric Thetford oven and grill
- Four-burner gas hob with electronic ignition
- Integrated microwave oven (800w)*
- Curved glass externally vented extractor fan unit with lights
- Integrated fridge and freezer
- Large L Shaped kitchen with shaker style doors
- Island unit with breakfast bar and two stools
- Soft close drawers
- White Mountain Larch 30mm laminate worktops with matching upstands
- Mains socket provision with USB
- Stainless steel single bowl drainer
- Freestanding Bella Twin table and six chairs
- Round wall mirror above side board unit
- White Wood style feature wall in dining area

BATHROOM(S)

- Main bathroom with domestic bath and thermostatic shower above and Inset vanity basin and towel cupboard
- En suite with Shower cubicle and thermostatic shower and inset vanity basin
- Tournai Stone effect vinyl flooring in bathroom(s)
- Dual flush WC
- LED illuminated vanity mirrors with infrared sensor and demisting pad
- Levanto Marble vanity splashbacks
- White towel radiators
- Extractor fan in main bathroom and en suite
- Vanity cupboard

MAIN BEDROOM

- King-size double bed in main bedroom with lift up storage, upholstered headboard and bedside units and wall lights
- King-size Duvalay™ Alba-Ortho; high-quality orthopaedic mattress providing enhanced orthopaedic care and support for backs, and topped with the finest springy wool for comfort and durability
- Vanity unit with mirror, drawer unit, cube stool and overhead TV position
- Walkthrough dressing area with large wardrobes

BEDROOM(S)

- Deep and luxurious Aurora Duvalay™ mattress with Crib 5 rated fabric (3ft wide single beds)
- Padded headboard(s)
- Twin bedroom featuring double wardrobe with drawers and vanity area with mirror, shelf, socket and cube stool
- Reading lights
- Curtains and voiles with poles (2 bed model)
- Roman blinds (3 bed model)
- TV sockets & Co-Ax to all bedrooms

FLOORPLANS

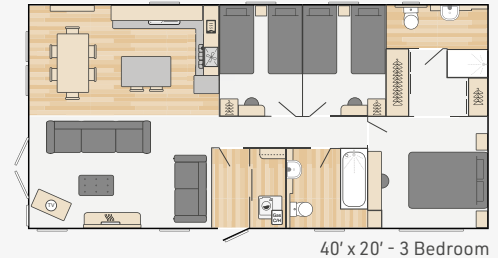
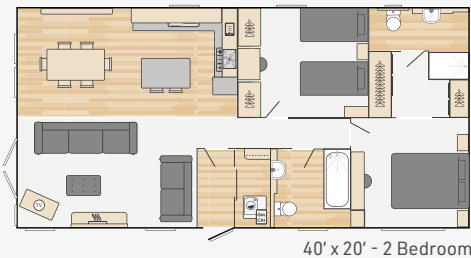

*The model fitted may differ from that shown in images, please check with supplying dealer or park



Escape the everyday in your own country retreat. Enhanced for 2022 with the **NEW** Acanthium soft furnishings scheme, Swift's highly popular Vendee Lodge blends rural character with modern looks. Offering residential specification for year-round getaways in the utmost comfort, the welcoming and cosy interior provides plenty of room for the whole family.

Model size	Bedrooms	Main Bed	Twin Beds
42' x 13'	2	2.02m x 1.53m (6'8" x 5'0")	1.90m x 0.75m (6'3" x 2'6")

VENDEE FEATURES

Along with the Swift Superior Standard (see page 4), Vendee also comes with many desirable extras including:

- Double Glazing
- Central Heating Boiler
- Cooker
- Electric Fire
- Wardrobe
- TV Point
- 7ft Wall Height
- Heated Towel Rails





Lift up under bed storage



Thermostatic shower

FEATURES

EXTERIOR

- Residential specification enhanced to BS3632:2015
- Strong I Beam twin-axle chassis with galvanised finish, warranted for ten years
- Bonded sandwich exterior wall construction for greater strength
- Coated steel pantile roof
- Distinctive pre-coated 'folded' steel bargeboards with LED lighting to front aspect
- CanExel high density wood composite cladding with durable, realistic woodgrain texture in Mist Grey with anthracite window frames
- Front aspect French doors
- uPVC windows with push-button security locks
- PVC gutters and down pipes

INSULATION

- Excellent thermal performance and sound insulation:
 - 'Thermaglas' uPVC double glazed windows and doors with improved thermal rating
 - Composite SIPs (Structural Insulated Panel) floor
 - 200mm insulation in roof
 - 95mm insulation in walls
 - Lagged underfloor pipes

INTERIOR

- 7ft (2.13m) high ceilings at side walls
- **NEW** 'Acanthium' soft furnishing scheme
- Luxury carpet with underlay
- Hardwearing vinyl flooring in Almeria for the kitchen/dining/bathroom(s)
- Nebraska Oak woodgrain
- Modern planked ceiling system
- Condensing gas combi-boiler central heating and hot water system with radiator thermostat
- Low energy LED lighting
- USB sockets
- Double electric sockets throughout

ENTRANCE HALLWAY

- Seat bench featuring coat hooks and shoe storage
- Large mirror and wall unit

LOUNGE

- Freestanding two-seater and three-seater sofas with scatter cushions
- Complementary footstool with storage
- TV unit with storage, TV provision and Sky TV cable for connection only to TV cabinet
- Additional high level TV point
- Contemporary electric 2kW Optiflame® stove feature fire with mirror over fireplace
- Central Tyler copper effect pendant light feature
- White slatted wooden blinds
- Full height luxury curtains to front aspect
- Contemporary framed colour wall pictures

KITCHEN / DINING

- Belling stainless steel oven
- Five-burner gas hob with central wok burner with electronic ignition
- Integrated microwave oven (800w)*
- Integrated externally vented silver extractor hood
- Integrated fridge and freezer
- Kitchen with country classic feel. Cupboards in Dakar with Larch woodgrain details, and copper cup door and drawer handles
- Soft close drawers
- 40mm Brown Mountain Larch laminate worktops
- White resin bowl and drainer with copper finish tap
- Brown Mountain Larch splashbacks
- Integrated wine rack
- Florence dining table in Nebraska Oak/Painted Porcelain with four Combo chairs

BATHROOM(S)

- Shower cubicle with thermostatic shower, topper and LED downlights
- Dual flush WC with soft close toilet seat
- White heated towel rails
- Vanity storage unit with mirror above
- Additional side storage cupboards
- Extractor fan in both bathrooms

BEDROOMS

- King-size Alba Ortho double bed in main bedroom with lift up storage
- **NEW** deeper and more luxurious Aurora Duvalay™ single mattresses with Crib 5 rated fabric
- Padded headboard in main bedroom
- Ample storage with bedside units and over bed cupboards in the main bedroom
- Wall mounted bedside lights
- Dressing table with mirror, lighting and storage
- Window seat and TV panel with credenza drawer unit in main bedroom
- Nature inspired wall pictures
- **NEW** TV sockets and Co-Ax to all bedrooms, plus booster

FLOORPLAN

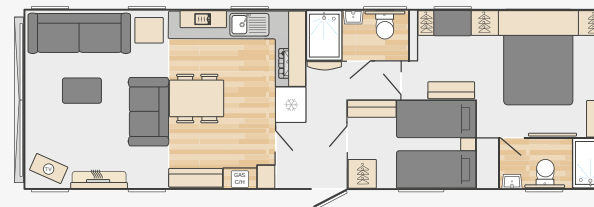

42' x 13' - 2 Bedroom

OPTIONS

- Lux Pack:
 - Dishwasher
 - Washing machine
 - VELUX window in kitchen
 - Bluetooth® audio connection to lounge ceiling speakers
- Freestanding three-seater sofa with fold out occasional bed, replacing standard three-seater sofa
- CanExel woodgrain exterior in environmental Acadia green with anthracite grey window frames
- CanExel woodgrain exterior in Sierra brown with brown window frames
- Wireless programmable room thermostat
- Shaving socket in bathroom
- SwiftShield stain resistant fabric

*The model fitted may differ from that shown in images, please check with supplying dealer or park









'Country Cottage' interior scheme

Moselle Lodge is set to impress with our first customisable front lounge – ensuring you can enjoy the best view from your sofa. Offering a choice of two interior design schemes, Moselle promises an escape to the country with calming vibes or an escape to Scandinavia with its bold on-trend design featuring 'pops' of black. As with all our lodges, Moselle comes with added assurance from the BS 3632 residential specification, including superb thermal performance and combi-boiler central heating, so you can enjoy time away all-year round.

Model size	Bedrooms	Main Bed	Twin Beds	Rear Twin Beds
40' x 13'	2	2.02m x 1.53m (6'8" x 5'0")	1.90m x 0.75m (6'3" x 2'6")	
42' x 14'	2	2.02m x 1.53m (6'8" x 5'0")	1.83m x 0.92m (6'0" x 3'0")	
42' x 14'	3	2.02m x 1.53m (6'8" x 5'0")	1.90m x 0.75m (6'3" x 2'6")	1.90m x 0.92m (6'3" x 3'0")
			1.83m x 0.75m (6'0" x 2'6")	1.83m x 0.75m (6'0" x 2'6")

MOSELLE FEATURES

Along with the Swift Superior Standard (see page 4), Moselle also comes with many desirable extras including:

- 
Double Glazing
- 
Central Heating
Boiler
- 
Cooker
- 
TV Point
- 
Wardrobe
- 
Configurable
lounge



'Scandinavian' interior scheme shown in Moselle Holiday Home



'Country Cottage' interior scheme



'Country Cottage' interior scheme



'Country Cottage' interior scheme



'Country Cottage' interior scheme



'Country Cottage' interior scheme

FEATURES

EXTERIOR

- Residential specification enhanced to BS3632:2015
- Protech galvanised chassis with finish warrantied for 10 years
- Bonded 'sandwich' exterior wall construction for greater strength
- Coated steel pantile roof
- Distinctive pre-coated 'folded' steel bargeboards with LED lighting to front aspect
- CanExel high density wood composite cladding with durable realistic woodgrain texture in Timberwolf with Anthracite window frames
- Front aspect sliding doors
- uPVC windows with push-button security locks
- PVC gutters and down pipes
- Low energy exterior side light

INSULATION

- Excellent thermal performance and sound insulation:
 - 'Thermaglas' uPVC double glazed windows and doors with improved thermal rating
 - Composite SIPs (Structural Insulated Panel) floor
 - 200mm insulation in roof
 - 95mm insulation in walls
 - Lagged underfloor pipes

INTERIOR

- Choice of two interior schemes - Scandinavian or Country Cottage
- 7ft (2.13m) interior side wall ceiling height
- Condensing gas combi-boiler central heating and hot water system
- Radiator thermostats
- Luxury carpet with underlay throughout
- Tournai Stone vinyl flooring in kitchen/dining/bathroom(s) and Almeria Black flooring in en suite
- Modern Nebraska Oak woodgrain
- Cloakroom area with upholstered seat and shoe rack
- Low energy LED lighting throughout
- USB sockets
- Double electric sockets throughout

LOUNGE

- Configurable lounge layout with TV points at both sides of lounge with Co-Ax and 240V socket
- Large freestanding sofa with footstool
- Freestanding armchair
- Freestanding TV station
- Oval coffee table
- Provision for flat screen TV and Sky TV cables (for connection only)

- Full width lined curtains to front aspect sliding doors
- LED atmospheric lighting in lounge to curtain pelmets

KITCHEN / DINING

- Thetford Cocina glass fronted oven and grill with electronic ignition
- Four-burner gas hob with electronic ignition
- Built in cooker extractor vented to the outside
- Integrated black microwave
- Large hob glass splashback
- Full height integrated fridge freezer
- Nebraska Oak 40mm laminate worktops with matching upstands
- Cast resin sink bowl and drainer with tap
- Full height storage cupboard
- Modern open plan dining area with table, fixed seating and two stools

BATHROOM(S)

- Main bathroom with domestic bath and thermostatic shower above
- En suite features large shower cubicle with thermostatic shower mixer and LED
- downlighting
- Concealed dual flush WC in main bathroom
- Full-width Nebraska splashbacks to sinks
- LED vanity spotlights
- Extractor fan in main bathroom and en suite

BEDROOMS

- King size Duvalay™ Alba-Ortho mattress, providing enhanced orthopaedic care and support for backs. Made with luxury nested pocket springs and topped with the finest springy wool for comfort and durability (main bedroom only)
- Duvalay™ Aurora mattress to all other beds with Crib 5 rated fabric, and featuring 'S-Line' pocket springs and a high density foam layer for increased and lasting comfort
- Large double wardrobe and vanity area in main bedroom
- Bedside cabinets
- LED atmospheric lighting in bedrooms to curtain pelmets and wardrobe tops
- Wall lights in bedroom(s)
- Vanity area with mirror and socket (twin bedroom only)
- TV sockets & Co-Ax to all bedrooms including booster
- USB points in all bedrooms

OPTIONS

- CanExel woodgrain exterior in Sierra brown with anthracite grey window frames
- CanExel woodgrain exterior in Mist Grey with anthracite grey window frames
- CanExel woodgrain exterior in environmental Acadia green with anthracite grey window frames
- Corelux cladding in environmental Acadia green with anthracite grey window frames
- Corelux cladding in Timberwolf grey with anthracite grey window frames
- Lux pack - dishwasher, washing machine, Dinette VELUX and Bluetooth® audio connection to lounge ceiling speakers
- Large freestanding sofa with fold-out occasional bed, replacing large standard sofa
- Wireless programmable room thermostat with gas central heating
- Shaving socket in bathroom

SCANDINAVIAN INTERIOR DESIGN SCHEME	COTTAGE COUNTRY INTERIOR DESIGN SCHEME
FIKA soft furnishing scheme	Acanthium soft furnishing scheme
Wide Venetian blinds to lounge side window (including dinette)	Curtain to lounge side window (excluding dinette)
Kitchen with a modern Scandinavian feel, featuring Light Grey and Dust Grey kitchen doors with modern black door handles	Kitchen with country classic feel, featuring shaker style cupboards in Dakar Grey with brass cup drawer handles
Kitchen roller blind in Carnival Shadow	Kitchen roller blind in Carnival Papaya
Black cast resin sink bowl and drainer with matching black tap	White cast resin sink bowl and drainer with brass tap
Concrete effect dining table	Nebraska Oak Top Galway dining table with white frame
Main bedroom doors in Light Grey	Main bedroom doors in Dakar Grey
Aluminium wall lights in bedroom(s)	Brass reading and wall lights in bedroom(s)

FLOORPLANS

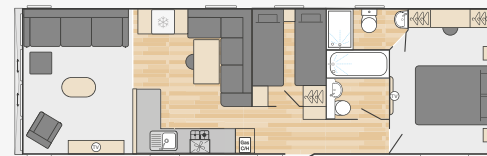

40' x 13' - 2 Bedroom

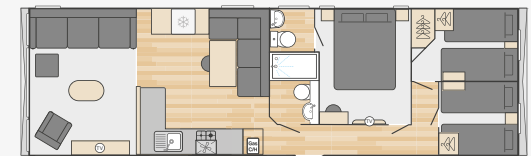

42' x 14' - 3 Bedroom

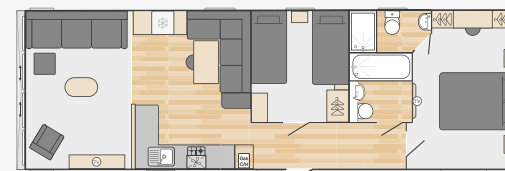

42' x 14' - 3 Bedroom

*The model fitted may differ from that shown in images, please check with supplying dealer or park

THE RANGE AT A GLANCE

	TORONTO	EDMONTON	VENDEE	MOSELLE
Exterior				
BS3632-2015 Residential specification	•	•	•	•
Strong I Beam or Fusion twin-axle chassis with galvanised finish warrantied for 10 years	•	•	•	Protech galvanised chassis
Bonded 'sandwich' exterior wall construction	•	•	•	•
Coated steel pantile roof	•	•	•	•
Distinctive 'folded' steel bargeboards with lighting	•	•	•	•
CanExel high density wood composite cladding	•	•	•	•
Front aspect French doors	•	Optional sliding doors	•	Sliding doors
uPVC windows with push-button security locks	•	•	•	•
PVC gutters and down pipes	•	•	•	•
Low energy exterior light	•	•	•	•
Exterior door to main bedroom	Optional hinged	Optional hinged		
Environmental exterior	Optional	Optional	Optional	Optional
Insulation				
'Thermaglas' uPVC double glazing	•	•	•	•
Composite SIPs (Structural Insulated Panel) floor	•	•	•	•
Insulation thickness in roof	200mm	200mm	200mm	200mm
Insulation thickness in walls	95mm	95mm	95mm	95mm
Lagged underfloor pipes	•	•	•	•
Interior				
Condensing gas combi-boiler central heating and hot water system with TRV	•	•	•	•
Radiator thermostats	•	•	•	•
Luxury carpet with underlay throughout	•	•	•	•
Heavy duty, durable vinyl flooring in uncarpeted rooms	•	•	•	•
Low energy LED lighting throughout	•	•	•	•
Planked interior ceiling system	•	•	•	
USB double socket	•	•	•	•
Woodgrain	Nebraska Oak	Tisano Oak	Nebraska Oak	Nebraska Oak
SwiftShield stain resistant fabric			Optional	
Wireless programmable room thermostat with gas central heating	•	Optional	Optional	Optional
Lounge				
Freestanding sofa(s) with scatter cushions	•	•	•	•
Armchair	•			•
Pull-out sofa bed mechanism	Optional	Optional	Optional	Optional
2 upholstered cube stools stored under coffee table	•			
Coffee table	•	Upholstered foot stool	Upholstered foot stool	•
Contemporary electric fire	•	•	•	
40" branded TV	•			
Provision for Sky+ connection	•		•	•
Bluetooth audio connection to lounge ceiling speaker		Optional	Optional (with Lux Pack)	Optional (with Lux Pack)
Large framed wall pictures/mirror	Large mirror	1	1	

	TORONTO	EDMONTON	VENDEE	MOSELLE
Kitchen/dining				
Glass fronted oven and grill with electronic ignition	•	•	•	•
Stainless steel cooker hood with extractor vented to outside	•	Glass	Built in extractor	Built in extractor
4-burner gas hob with electronic ignition	5-burner inc wok burner	•	5-burner inc wok burner	•
Integrated fridge and freezer	•	•	•	•
Microwave oven	•	•	•	•
Wine cooler	•			
Integrated 12 place setting dishwasher	•	Optional	Optional (with Lux Pack)	Optional (with Lux Pack)
Built-in washing machine with furniture door			Optional (with Lux Pack)	Optional (with Lux Pack)
1½ sink bowl/drain	1½ bowl Black Granite	Single Stainless Steel	Single White Granite	White or Black Cast Resin Bowl & Drainer
Laminate worktops with matching upstands	40mm	30mm	40mm	40mm
Soft shut drawers	•	•	•	
VELUX rooflight in kitchen ceiling	•		Optional (with Lux Pack)	Optional (with Lux Pack)
Freestanding dining suite	•	•	•	Fixed
Lux pack - dishwasher, washing machine, VELUX window in kitchen and Bluetooth® audio connection to lounge ceiling speakers			Optional	Optional
Cupboard housing gas central heating boiler			•	•
Utility room				
Gas central heating boiler	•	•		
Freestanding washer/dryer	•	Optional		
Washrooms				
Shower cubicle with thermostatic shower in main bathroom	•		•	
Bath with thermostatic shower over	2 bed model	Main Bathroom		Main Bathroom
Dual flush WC	•	•	•	•
Extractor fan in main bathroom and en suite	•	•	•	•
Chrome finish towel radiator in main bathroom and en suite	•	White	White	
LED vanity lighting	Lit mirror	Lit mirror	•	•
Shower cubicle top	(Open with LED light)	Open	(with LED light)	(with LED light)
Shaver socket in bathroom	Optional	Optional	Optional	Optional
Bedrooms				
King-size double bed in main bedroom with Alba Ortho Mattress	•	•	•	•
Gas strut assisted lift-up bed allowing easy access to storage area	•	•	•	
Duvalay™ Crib 5 mattress	•	•	•	•
Padded headboard(s)	•	•	Main Bedroom	
Reading lights	•	•	•	•
TV sockets & Co-Ax to all bedrooms plus booster	•	•	•	•
Sliding glass wardrobe to main bedroom	3 bed hinged / 2 bed sliding			
Walk-in wardrobe in main bedroom	Dressing room in 2 bed	•		
Safety				
Smoke alarm with 10-year battery	•	•	•	•
5-year carbon monoxide detectors	•	•	•	•
Fire extinguisher	•	•	•	•

THE SWIFT DIFFERENCE

As a leading manufacturer of holiday homes, touring caravans and motorhomes, we know just how to create the perfect retreat for your getaways. We apply this design and innovation excellence to all of our products, taking the time to understand what makes your breaks so special. We incorporate this understanding in superb specifications, impeccable looks and creative space solutions - and because we work with some of the industry's most trusted suppliers, you can be assured that everything is of the highest standard both inside and out.



CONSTRUCTION AND HIGH THERMAL EFFICIENCY

Swift's holiday home range is built to BS EN 1647, and meets the National Caravan Council (NCC) Structural Thermal Rating Scheme for Caravan Holiday Homes, which gives an indication of the likely thermal efficiency of the holiday home.

Swift's lodge range is built to BS 3632, and meets the NCC Energy Efficiency Rating Scheme for Residential Park Homes. This specification sets a higher standard for thermal efficiency through improvements in roof, wall and floor insulation.

DOUBLE GLAZING

In response to the demand for more energy-conscious living, heat reflecting 'Thermaglas' double glazing with a 16mm air space is fitted as standard or as an option on our holiday home ranges. All lodges are fitted with 'Thermaglas' as standard.

CHASSIS

Swift only specify fully galvanised chassis as standard. What's more, every Swift holiday home and lodge comes with a 10-year anti-corrosion warranty.

ROOF TRUSSES

For accuracy, strength and reliability, all Swift holiday homes and lodges use prefabricated roof trusses. The resulting roof strength meets Grade B snow loading (capable of carrying half a metre of settled snow), while a minimum of 90mm glass wool insulation in holiday homes, and 200mm in lodges, provides excellent thermal efficiency.

ENVIRONMENTAL CHAMBER TEST

Swift tests its holiday homes in an environmental chamber to optimise the heating and ventilation levels and measure thermal performance. Thermal imaging helps to ensure the products are fully designed and engineered to meet the requirements of a modern holiday home.

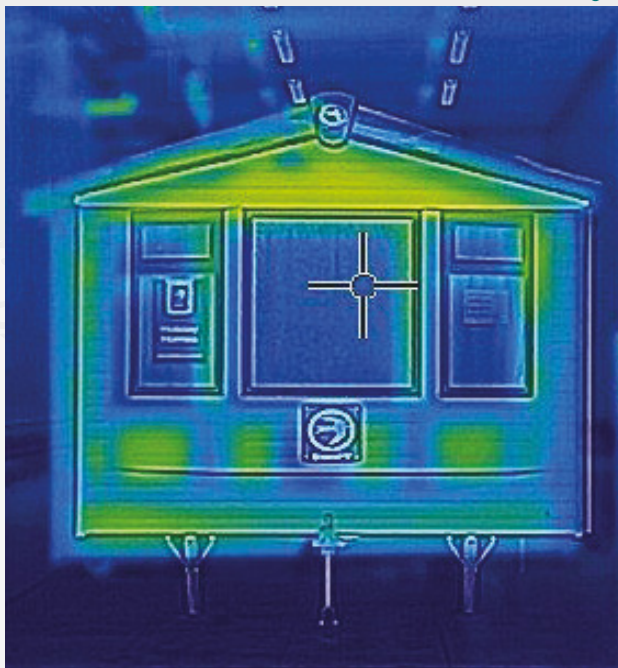

WALL CONSTRUCTION

All Swift holiday homes and lodges benefit from bonded 'sandwich' exterior wall construction for greater structural strength. The walls are made in modules approximately 3m x 2m and are clad with aluminium, CanExel and Corelux. Each module consists of a robust timber frame, battened out and filled with insulation and a plywood inner skin. For lodges, the outer surface is constructed of a breathable moisture membrane.

FLOOR CONSTRUCTION

The flooring in Swift holiday homes is constructed from timber joists much like a traditional home. Class-leading 50mm glass wool insulation is placed between the joists and the floor is covered with a breathable membrane and with a waterproof finish for durability.

In Swift lodges, the thermal efficiency is enhanced with Structural Insulated Panel (SIPs) flooring, consisting of a timber frame with floorboards either side, which is injected with polyurethane, giving a greater level of insulation for all year round living.

SAFETY COMES FIRST

All our holiday homes and lodges are built in accordance with British and European standards and are audited against these build standards by the National Caravan Council (NCC).



DIMENSIONS

- L1** Overall length including detachable towbar
- L2** Overall length excluding detachable towbar
- L3** Body length (including bay where applicable)
- L4** Body length at floor level
- W1** Overall width including gutters and down pipes
- W2** Width at floor level
- H1** Overall height

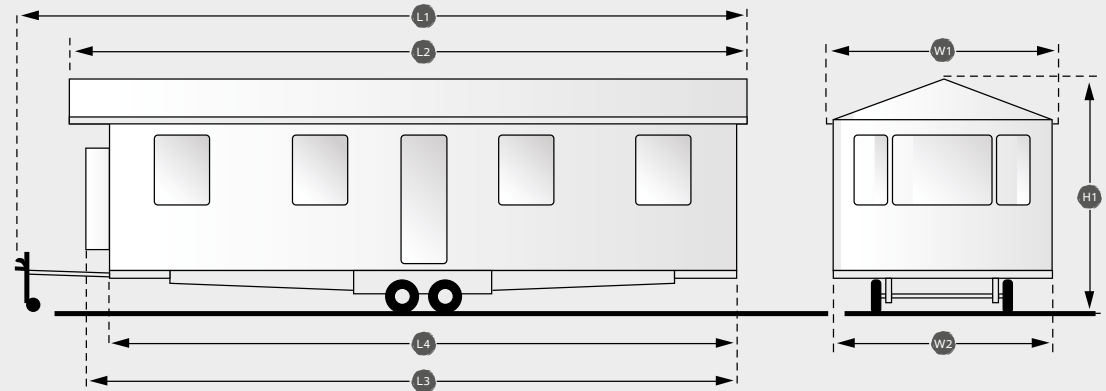

Model	L1	L2	L3	L4	W1	W2	H1
Toronto Lodge 40x20-2 bed	13.20m (43'3")	12.70m (41'8")	12.37m (40'7")	12.37m (40'7")	6.42m (21'1")	6.15m (20'2")	4.08m (13'4")
Toronto Lodge 42x20-3 bed	13.68m (44'10")	13.18m (43'3")	12.85m (42'2")	12.85m (42'2")	6.42m (21'1")	6.15m (20'2")	4.08m (13'4")
Edmonton Lodge 40x20-2 bed	13.27m (43'6")	12.77m (41'11")	12.34m (40'6")	12.34m (40'6")	6.42m (21'1")	6.15m (20'2")	4.13m (13'6")
Edmonton Lodge 40x20-3bed	13.27m (43'6")	12.77m (41'11")	12.34m (40'6")	12.34m (40'6")	6.42m (21'1")	6.15m (20'2")	4.13m (13'6")
Vendee Lodge 42x13-2 bed	13.57m (44'6")	13.15m (43'2")	12.77m (41'11")	12.77m (41'11")	4.29m (14'1")	4.01m (13'2")	3.75m (12'4")
Moselle Lodge 40x13-2 bed	12.93m (42'5")	12.64m (41'6")	12.24m (40'2")	12.24m (40'2")	4.29m (14'1")	4.01m (13'2")	3.75m (12'4")
Moselle Lodge 42x14-2 bed	13.53m (44'5")	13.15m (43'2")	12.86m (42'2")	12.86m (42'2")	4.59m (15'1")	4.32m (14'2")	3.83m (12'7")
Moselle Lodge 42x14-3 bed	13.53m (44'5")	13.15m (43'2")	12.86m (42'2")	12.86m (42'2")	4.59m (15'1")	4.32m (14'2")	3.83m (12'7")

Est. = Estimate

SWIFT WARRANTY SCHEME

You can rest assured that your Swift lodge comes with a comprehensive warranty, allowing you to simply relax and enjoy your home.



3-YEAR SUPERSURE WARRANTY

Your lodge has 3-year cover for all parts and fittings (other than the structural exterior).

This includes items like:

- Freestanding furniture
- Kitchens
- Showers
- Sanitaryware
- Sockets and switches
- Interior doors and integrated furniture
- Gutter and fall pipes



5-YEAR STRUCTURAL WARRANTY

Your lodge has a 5-year Structural Warranty and Swift will repair (or, at its option, replace) any defects with the structural integrity of the home that come to light and are notified to Swift during the warranty period.

The Structural Warranty covers any defect with the seams of the lodge, including water ingress through any permanently sealed seam joints and also items like:

- External doors
- uPVC windows
- Roof, walls and ceilings
- Carpets



10-YEAR CHASSIS WARRANTY

Your lodge has a fully galvanised chassis with a 10-year Chassis Warranty, subject to maintenance. Swift will repair (or, at its option, replace) any defects with the chassis that come to light during this period, but only for as long as the home belongs to its first owner.

All warranties start from the date an approved Swift Group dealer or park operator transfers the unit to its first owner and are subject to conditions, terms and exclusions. For full details see www.swiftgroup.co.uk/owners/handbooks.

*Other than the structural exterior. **Only for as long as the unit belongs to its first owner



EXTERIOR FINISHES & SOFT FURNISHINGS

Swift lodges are designed for long-lasting great looks, both inside and out. The exterior is clad in CanExel high density wood composite cladding with durable, realistic woodgrain texture for a superb finish, while a range of natural colour treatments add extra character. Corelux cladding is also available as an option on selected ranges. Corelux is a two-tone wood-texture effect premium cladding that boasts a thicker alloy aluminium plank that can withstand extreme weather. Its durability also extends to a UV protection coating that prevents fading, degrading and expansion.

TIMBERWOLF

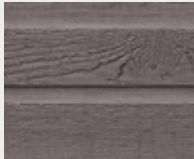

CLIFFSIDE



MIST GREY



TIMBERWOLF (CORELUX)

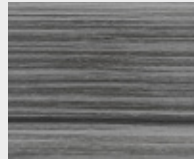

SIERRA BROWN



ACADIA GREEN



ACADIA GREEN (CORELUX)

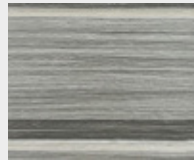

CLADDING	CLIFFSIDE	TIMBERWOLF & MIST GREY	TIMBERWOLF	MIST GREY	SIERRA BROWN	ACADIA GREEN	ACADIA GREEN (CORELUX)	TIMBERWOLF (CORELUX)
Models								
TORONTO LODGE		•		•	•	•		
EDMONTON LODGE	•			•	•	•		
VENDEE LODGE				•	•	•		
MOSELLE LODGE			•	•	•	•	•	•



Standard exterior finish



Optional exterior finish

SWIFTSHIELD

Selected Swift lodges are available with the exclusive option of SwiftShield fabric. SwiftShield fabric has a soft suede-type feel and has been cleverly treated during manufacturing to resist stains. It is very easy to clean and requires only a soft cloth dampened with water to remove most stains.

For full details, please go to www.swiftgroup.co.uk

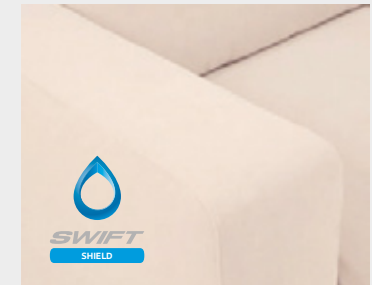

COMPARE AT A GLANCE

SwiftShield Colour Options

	TORONTO	EDMONTON	VENDEE
LATTE (908)			•
STONE (960)		•	•
PEBBLE (976)	•	•	
DENIM (78)	•		

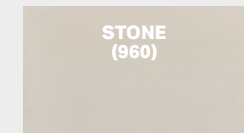
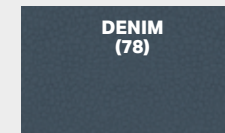



ONLY SWIFT APPROVED PARTNERS SELL APPROVED SWIFT HOLIDAY HOMES AND LODGES

Swift wants to make sure your buying experience is the best it can be. When you buy from a Swift Approved Partner, you can rest assured that your lodge is fully supported by Swift Group and the supplying distributor.

The benefits of buying from a Swift Approved Partner include:

- Swift Group Approved Warranty
- Dealer access to Swift Connect aftersales support
- Approved spare parts
- Approved engineers
- Access to Swift Approved technical engineers
- Product on display at distributors
- Financial services to help with your purchase*

Find your nearest Swift Approved Partner from our list on the back of the brochure or the Swift Group website, www.swiftgroup.co.uk, and look out for the Swift Approved Partner signs in dealerships.

* Subject to status



Find out more at swiftgroup.co.uk



Brochures



Layouts



Dealer



Social

A person is splashing water in the ocean at sunset. The water is splashing upwards and to the left, creating a large spray of water droplets. The person's arm is raised on the right side of the frame. The background is a bright orange and yellow sunset sky over the ocean. The text "Love life" is written in a white, cursive font across the center of the image, and "LOVE SWIFT" is written in a smaller, white, sans-serif font below it.

Love life

LOVE SWIFT





SWIFT
CREATING SMILES FOR LIFE

DEALERS

Cumbria

Kendal Caravans
Kendal
Tel: 01539 823659
kendalcaravans.co.uk

Devon

Surf Bay Leisure
Winkleigh
Tel: 01837 680100
surfbayleisure.co.uk

Dorset

Surf Bay Leisure
Bridport
Tel: 01308 427444
surfbayleisure.co.uk

Durham

Ideal Caravans
Durham
Tel: 0191 378 0146
idealcaravans.co.uk

East Midlands

Don Amott Leisure Kingdom
Derby
Tel: 01283 732193
donamottparks.com

Hampshire

PM Leisure
Hayling Island
Tel: 023 9246 7722
pmleisure.co.uk

Lancashire

Westfield Caravans
Blackpool
Tel: 01253 301505
westfieldcaravans.co.uk

Lincolnshire

Seymours Caravans
Skegness
Tel: 01754 764270
seymourscaravans.co.uk

TLC Skegness

Skegness
Tel: 01754 875050
theleisurecompany.co.uk

Norfolk

McDonnell Caravans
Kings Lynn
Tel: 01553 636243
mcdonnellcaravans.co.uk

Parklands Leisure

Wells-next-the-Sea
Tel: 01328 710166
parklandsleisure.co.uk

Pioneer Caravans

Peterborough
Tel: 01733 222244
pioneercaravans.co.uk

Shropshire

Salop Leisure Ltd
Shrewsbury
Tel: 01743 282400
salopleisure.co.uk

Somerset

Surf Bay Leisure
Bream
Tel: 01278 751171
surfbayleisure.co.uk

Yorkshire

Bridlington Caravan Centre
Bridlington
Tel: 01262 606777
bridlingtoncaravans.com

Yorkshire Holiday Homes

Wetherby
Tel: 01937 849128
yorkshirehh.co.uk

Northumberland

Ideal Caravans
Adderstone
Tel: 0191 378 6615
idealcaravans.co.uk

Worcestershire

Salop Leisure
Worcester
Tel: 01299 878872
salopleisure.co.uk

Northern Ireland

Sandycove Holiday Homes
Donaghadee
Tel: 028 4275 8200
sandycove.co.uk

Hayes Caravans

Dungannon
Tel: 0288 7767575
hayescaravans.com

Ireland

Harry Farrell & Sons Ltd
Dublin
Tel: +353 (0)1 458 9410
harryfarrellsons.ie

Scotland

Swalwell Holiday Group
Gatehouse of Fleet
Tel: 01556 506 200
swalwellholidaygroup.co.uk

Dee Valley Caravans

Aberdeen
Tel: 01330 811351
deevalleycaravans.co.uk

Wales

Blackhills Caravan Sales
Gower
Tel: 01792 851221
blackhillscaravansales.co.uk

Lloyds Caravan & Lodge Sales

Towyn
Tel: 01745 832050
lloydscaravans.co.uk

Salop Leisure

Machynlleth
Tel: 01654 705900
salopleisure.co.uk

Mon Caravans

Anglesey
Tel: 01248 711070
moncaravans.com



SWIFT
APPROVED PARTNER

Holland

Caravancentrum Roels
Tel: +32 (0)9 369 20 26
caravancentrumroels.be

Belgium

Caravancentrum Roels
Tel: +32 (0)9 369 20 26
caravancentrumroels.be

France

Picardy / Nord Pas de Calais
Caravancentrum Roels
Tel: +32 (0)9 369 20 26
caravancentrumroels.be

VISIT SWIFTGROUP.CO.UK



Layouts



Dealer



Video



Social



Brochures

DISCLAIMER

This brochure does not constitute an offer by Swift Group Limited (Swift). Swift reserves the right to alter specifications and prices at any time as materials and conditions demand. Distributors and dealers sell Swift products on their own account and not as agents of Swift. Accordingly, they have no authority to bind Swift or to make any representation or undertaking whatsoever on behalf of Swift. All props are for photographic purposes only and are not included in the specification. Models shown may be fitted with optional extras. Issued August 2021.

CARAVANS • MOTORHOMES • HOLIDAY HOMES - MADE IN BRITAIN BY SWIFT

